



**BUILDINOZ**  
build your best lifestyle

## What's the best way to create the perfect House & Land package?

It's as simple as taking this site plan to your building designer or builder and choosing or designing a floorplan that fits on it.

### Stage 15 Lot plan

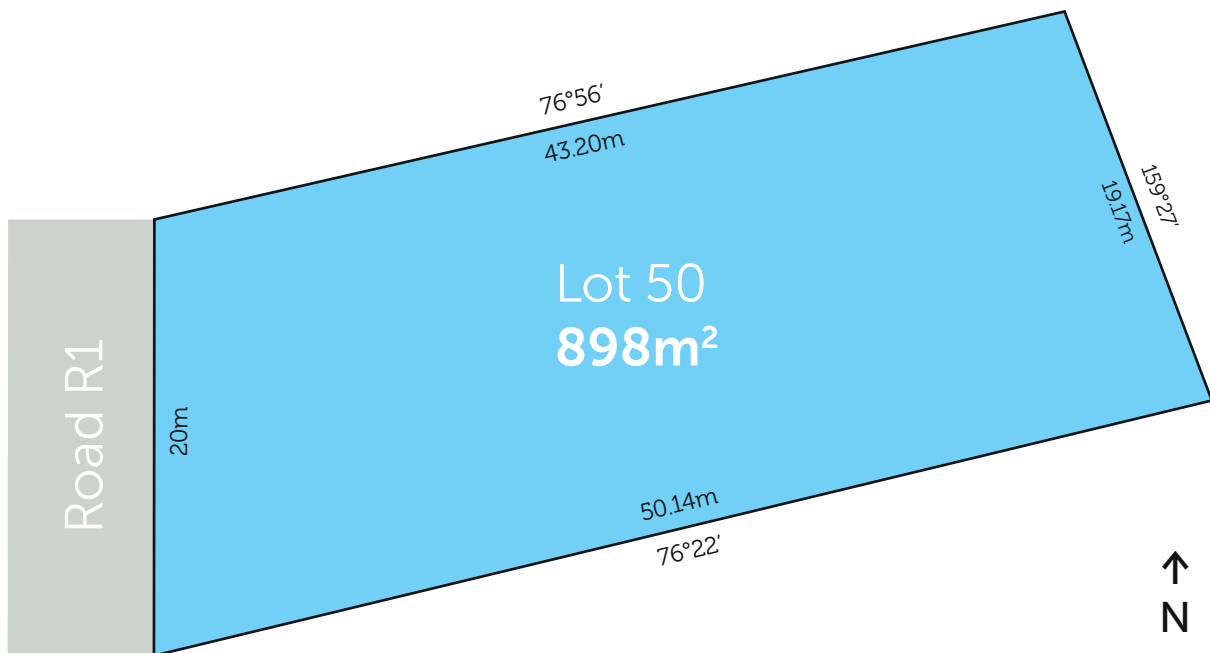

Want to know the price of this block?

Call Sam Stevens on 0408529843 or email [sam@landinwarrnambool.com.au](mailto:sam@landinwarrnambool.com.au)